

Springfield Plaza - ±5,000 SF & ±23,000 SF Retail Spaces For Lease

3600 W Sunshine St, Suite Springfield Plaza - ±23,000 SF of Retail Space For Lease | Springfield, MO | US | Greene County
Available SF: 23,000



Building Type:	Retail
Available SF:	23,000
Total SF:	23,000
Last Updated:	Jun 25, 2025

Economic Development Contact

Benjamin Vickers
Springfield Area Chamber of Commerce
202 S. John Q. Hammons Parkway
Springfield, MO 65806
| ben@springfieldchamber.com

Realtor/Owner Contact

Jeff Childs
| jeff.childs@svn.com

Property and Area Description

We are pleased to offer you this +/-5,000 SF & +/-23,000 SF retail space for lease in West Springfield! This retail space is right next to a Walmart Super Center and a new retail strip that opened up fall of 2017. The 158,000 SF Walmart features annual sales over \$80 Million. Located in West Springfield near the intersection of E Sunshine and West Bypass.

Population

	144,630 5 Mile Radius	298,336 10 Mile Radius	717,253 50 Mile Radius
--	---------------------------------	----------------------------------	----------------------------------

Source: ESRI®, 2024

Households

	63,563 5 Mile Radius	128,434 10 Mile Radius	291,721 50 Mile Radius
--	--------------------------------	----------------------------------	----------------------------------

Source: ESRI®, 2024

Transportation

Rail Served: No
Rail Accessible: No
Rail Infrastructure in Place: Unknown

Property Images

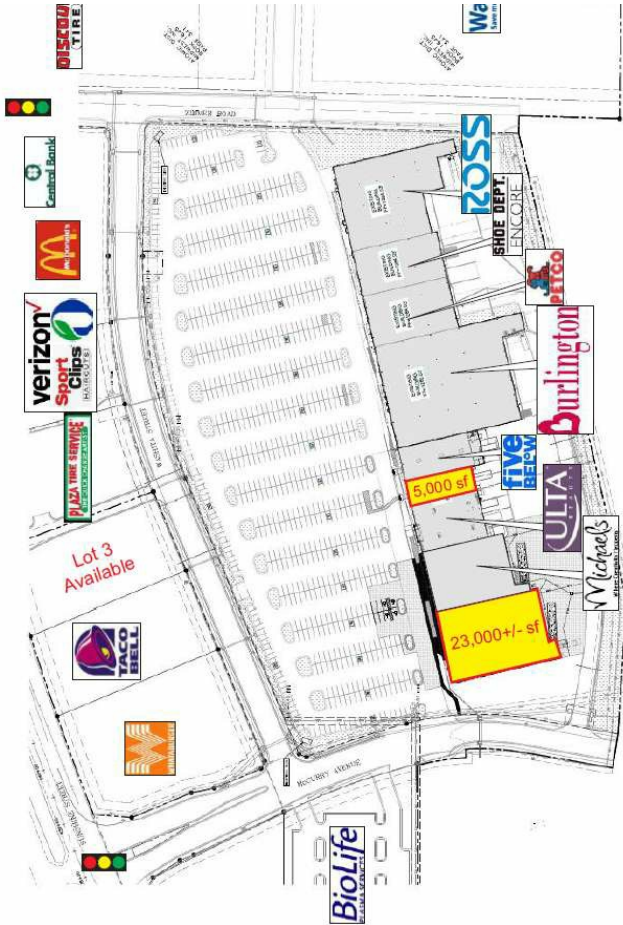

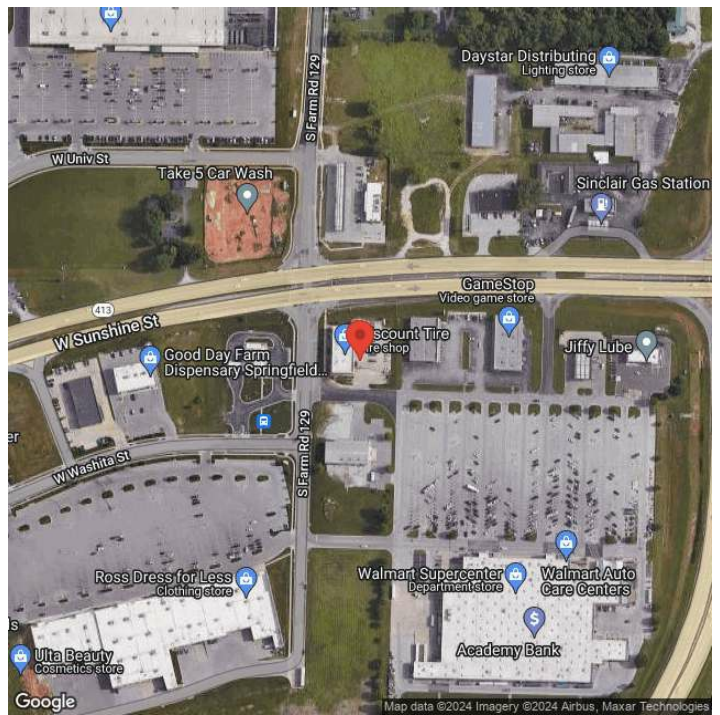

Ben Vickers | Manager of Business Development | Springfield Area Chamber of Commerce
 202 S. John Q. Hammons Parkway | Springfield, MO 65806 | (417) 450-6751 | ben@springfieldchamber.com