

Murray Warehouse

915 Floral Lane | Davenport, IA | US | Scott County

Available SF: 30,860 | Lease Rate: \$3.25 | Lease Terms: Triple Net



Building Type:	Commercial
Available SF:	30,860
Total SF:	30,860
Number of Stories:	0
Ceiling Peak:	22 Ft.
Expandable:	Unknown
Zoning:	Industrial-Heavy
Site Size:	2.31 Acres
Year Built:	1973
Specialty Features:	None
Can Subdivide:	Unknown
Within City Limits:	Unknown
Construction Type:	Metal or Steel
Floor Type:	Concrete-Reinforced
Lease Rate:	\$3.25
Lease Terms:	Triple Net
Lease Rate Note:	\$3.25 psf
Last Updated:	Jul 14, 2021

Population



265,216
10 Mile Radius

338,063
20 Mile Radius

422,674
30 Mile Radius

Source: ESRI®, 2024

Households



112,145
10 Mile Radius

141,262
20 Mile Radius

176,159
30 Mile Radius

Source: ESRI®, 2024

Transportation

Nearest Highway: US 61 (1.00 mi.)

Nearest Interstate: I-280 (8.00 mi.)

Nearest Airport: Davenport Municipal Airport (0.00 mi.)

Nearest Commercial Airport: Quad Cities International Airport (MLI) (14.00 mi.)

Rail Served: Unknown

Rail Served By: Other

Rail Infrastructure in Place: Unknown

Utilities

Electric: MidAmerican Energy

Natural Gas: MidAmerican Energy

Water: Iowa American Water

Sewer: City of Davenport

Economic Development Contact

Susanne Knutsen

City of Davenport

226 West 4th Street

Davenport, IA 52801

(563) 326-6179 |

Susanne.Knutsen@davenportiowa.com

Realtor/Owner Contact

Andy Doyle

QC Iowa Realty Commercial

563 322-6682 | adoyle@qciowarealty.com



A map of the northern part of Tehran, Iran, showing the location of the study area. The map includes major roads such as Vahdat Highway, Shahr-e Qods Highway, and Shahr-e Khatam-anbiya Highway. The study area is highlighted in red, located near the intersection of Vahdat Highway and Shahr-e Qods Highway. Other landmarks include the Vahdat Park and the Vahdat Market.



www.QC Iowa Realty.com

www.QC Iowa Realty.com

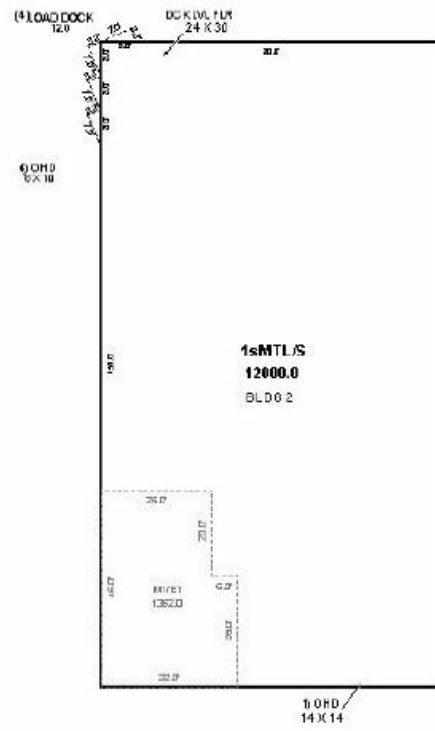
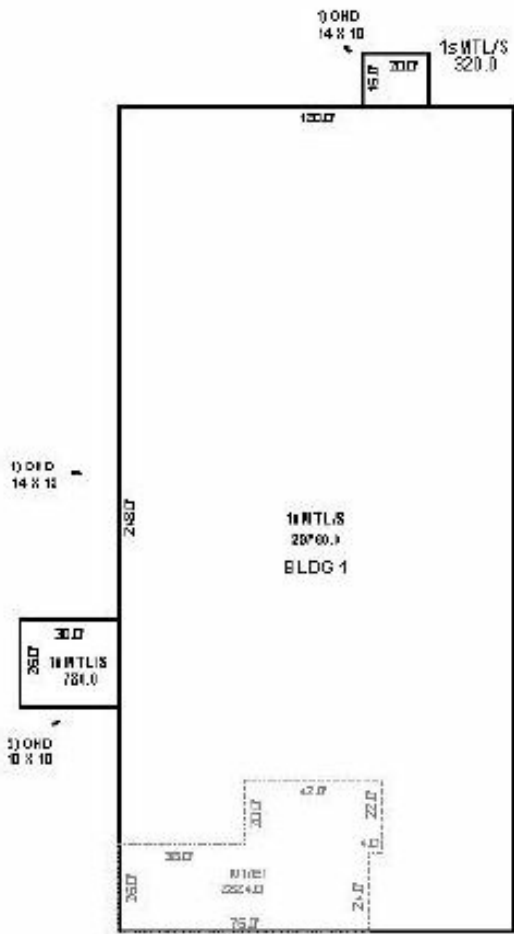

Tami Petsche | Vice President, Business & Economic Growth | Quad Cities Chamber
331 W 3rd Street | Davenport, IA 52801 | (563) 823-2655 | tpetsche@quadcitieschamber.com

LocationOne® Copyright 2001-2025 Global Location Technologies. This information has been secured from sources we believe to be reliable, but we make no representation or warranties, expressed or implied, as to the accuracy of the information.