



Building Type:	Industrial, Warehouse & Distribution
Available SF:	17,637
Total SF:	63,368
Number of Stories:	1
Ceiling Peak:	19 Ft.
Expandable:	Unknown
Zoning:	Industrial-Light
Site Size:	4.61 Acres
Year Built:	1991
Specialty Features:	None
Can Subdivide:	No
Within City Limits:	Yes
Construction Type:	Concrete Tilt-up
Floor Type:	Unknown
Lease Rate:	\$5
Lease Terms:	Unknown
Last Updated:	Nov 6, 2024

Economic Development Contact

Allison Schultz
Platte County Economic Development Council
11724 NW Plaza Circle
Kansas City, MO 64153
(816) 270-2119 | aschultz@plattecountyedc.com

Realtor/Owner Contact

Chris Cargill
Block Real Estate Company
(816) 412-8412 | ccargill@blockllc.com

Property and Area Description

17,637 SF available with build-to-suit office space. This available space includes: • 19'4" clear height • 4 dock-high doors (9' x 10') • 3 grade-level drive-in doors (11' x 14') • LED lighting in warehouse • I-635 access and visibility • 400 amp, 277/480, 3 phase electric service

Population

	2,680 1 Mile Radius	166,272 5 Mile Radius	551,921 10 Mile Radius
---	-------------------------------	---------------------------------	----------------------------------

Source: ESRI®, 2024

Households

	1,039 1 Mile Radius	68,158 5 Mile Radius	232,646 10 Mile Radius
---	-------------------------------	--------------------------------	----------------------------------

Source: ESRI®, 2024

Transportation

Nearest Highway: Missouri Highway 9 (0.00 mi.)
Nearest Interstate: I-635 (1.00 mi.)
Nearest Airport: Kansas City International Airport (13.8 mi.)
Nearest Commercial Airport: Kansas City International Airport (13.8 mi.)
Rail Served: No
Rail Served By: BNSF Railway
Rail Accessible: Unknown
Rail Infrastructure in Place: No

Utilities

Electric: Evergy - John Engelmann
Natural Gas: Spire
Water: Missouri American Water
Sewer: Missouri American Water

Property Images

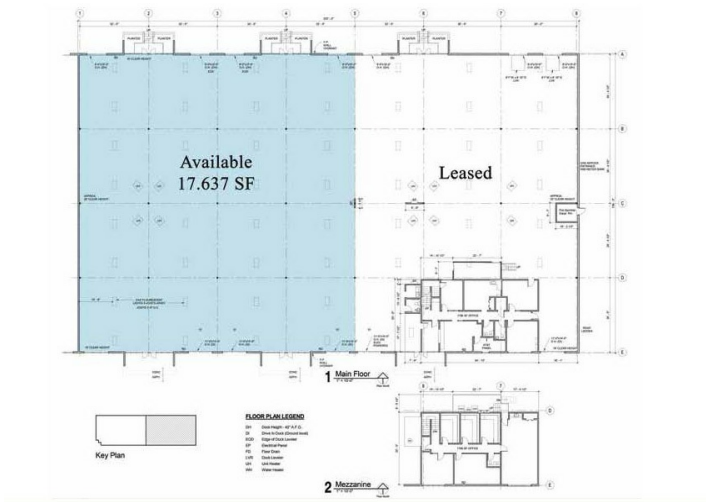

Allison Schultz | Marketing & Public Relations Manager | Platte County Economic Development Council
PO Box 14173 | Kansas City, MO 64152 | (816) 270-2109 | aschultz@plattecountyedc.com