

3021 1st Ave E, Newton
3021 1st Ave E | Newton, IA | US | Jasper County
Available Acres: 0.3 |



Zoning:
Last Updated: Aug 26, 2024

Economic Development Contact

Frank Liebl - Executive Director
Newton Development Corporation
403 W 4th St N, Suite 210
Newton, Iowa 50208
(641) 787-8209 | frankliebl.ndc@gmail.com

Tanya Michener - Associate Director
Newton Development Corporation
403 W 4th St N, Suite 210
Newton, Iowa 50208
(641) 787-8210 | tanyam.ndc@gmail.com

Realtor/Owner Contact

Ryan Fitzpatrick
| rfitzpatrick@iowaca.com

Population

	23,863 10 Mile Radius	62,086 20 Mile Radius	263,323 30 Mile Radius
--	---------------------------------	---------------------------------	----------------------------------

Source: ESRI®, 2024

Households

	9,337 10 Mile Radius	23,889 20 Mile Radius	101,438 30 Mile Radius
--	--------------------------------	---------------------------------	----------------------------------

Source: ESRI®, 2024

Transportation

Rail Served: Yes
Rail Served By: Union Pacific Railroad
Rail Accessible: Yes
Rail Infrastructure in Place: Unknown
Rail Contact: Darren Wisniski
Rail Contact Phone: 402-672-1983
Rail Contact Email: djwisnis@up.com

Property Images

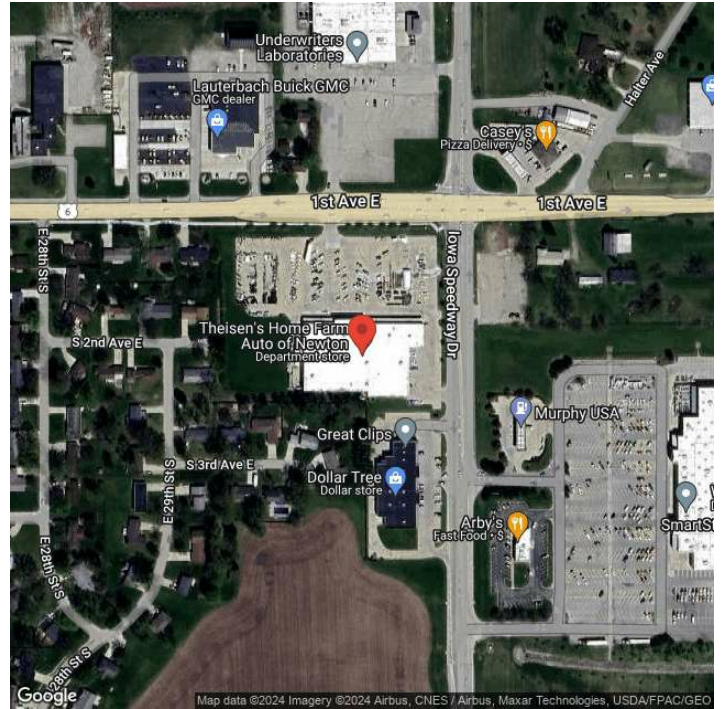
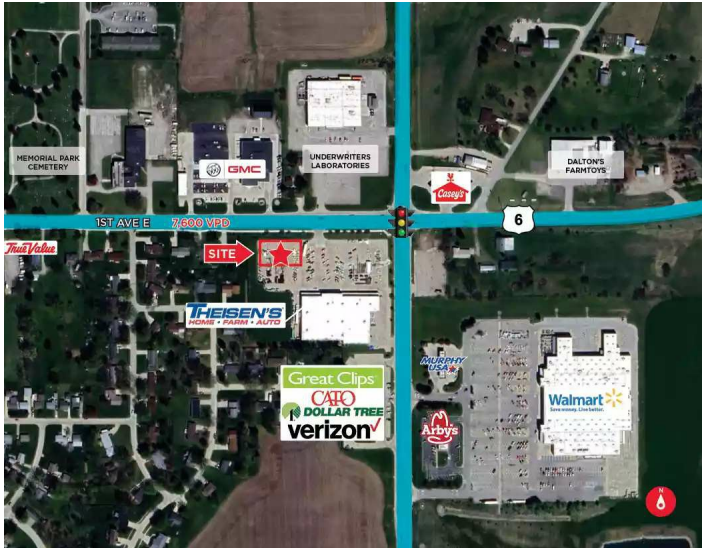

Jeff Davidson | Jasper County Economic Development Corporation (JEDCO)
315 W 3rd St N. | Newton, IA 50208 | (641) 417-9500 | JEDCOIowa@gmail.com